

Sit Here Tube Steel Table Base

Architectural Metalwork made in Olympia, Washington USA

PRODUCT DESCRIPTION

The Sit Here Tube Steel base is constructed of 2" x 2" x 1/8" tube steel and is available in three heights - 27", 32", or 40". A 1/4" x 5" x 5" securing plate with mounting holes is welded to the bottom and a 1/4" x 4" x 10" mounting plate welded to the top. Available with optional adjustable arm for wall attachment. The Sit Here Tube Steel table base is available in several natural and powdercoated finishes per the customers specifications. Our metalwork is custom made to order in Olympia, Washington USA.

SPECIFICATIONS

OVERALL DIMENSIONS

Leg Dimension is 1/8" x 2" x 2"

Available in three heights - 27", 32", 40"

1/4" x 5" x 5" securing plate is welded to the bottom

1/4" x 4" x 10" mounting plate welded to the top

Range of optional adjustable arm bracket 5.5" to 9"

MATERIAL AND FINISH

2" x 2" x 1/8" tube steel

MF20- Black (powdercoat)

MF21- Anthracite Gray (powdercoat)

MF22- Natural (clear powdercoat)

27" HIGH TABLE BASE ITEM NO.

TBSHTS-27 (1) 27" base without arm

TBSHTSA-27 (1) 27" base with arm bracket

32" HIGH TABLE BASE ITEM NO.

TBSHTS-32 (1) 32" base without arm

TBSHTSA-32 (1) 32" base with arm bracket

40" HIGH TABLE BASE ITEM NO.

TBSHTS-40 (1) 40" base without arm

TBSHTSA-40 (1) 40" base with arm bracket

WEIGHT

- TBSHTS-27 12.5 lbs
- TBSHTS-32 16.5 lbs
- TBSHTS-40 20 lbs



Sit Here Tube Steel Base (TBSHTS)

SIT HERE COLLECTION



MF20
Black

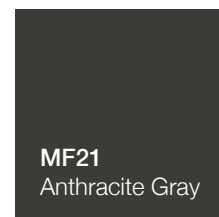

MF21
Anthracite Gray



MF22
Natural



Windfall Lumber

711 Tumwater Blvd SW Suite D
Tumwater WA 98501
360-352-2250
www.windfalllumber.com



Sit Here Tube Steel Table Base

Architectural Metalwork made in Olympia, Washington USA

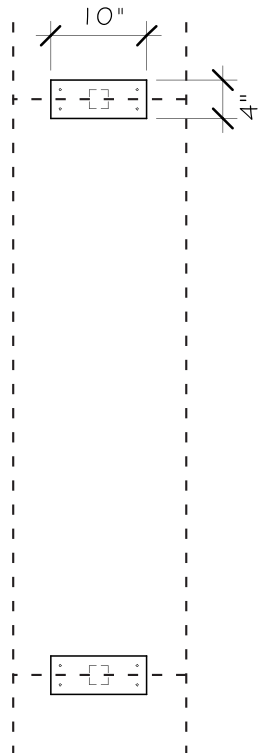

Plan View

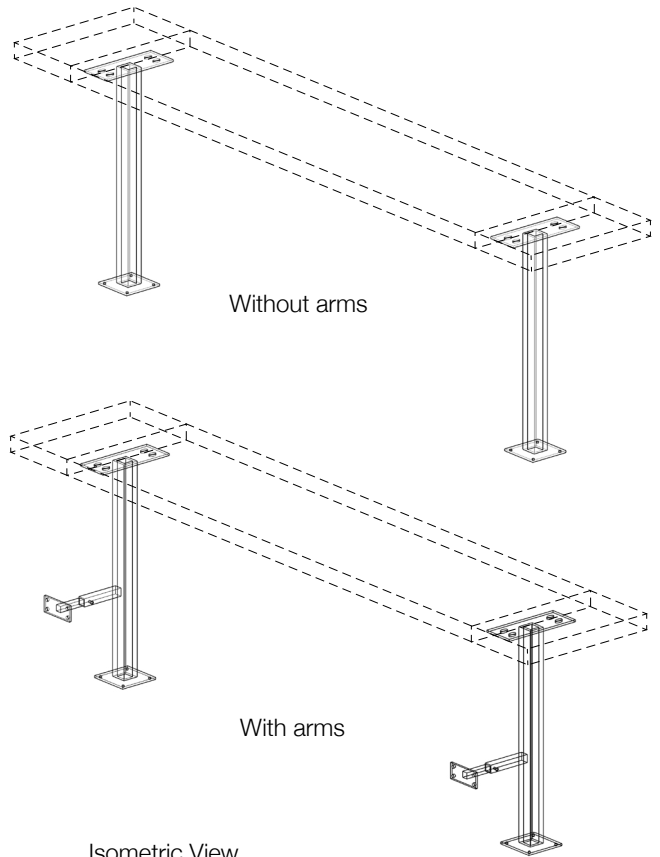

Isometric View

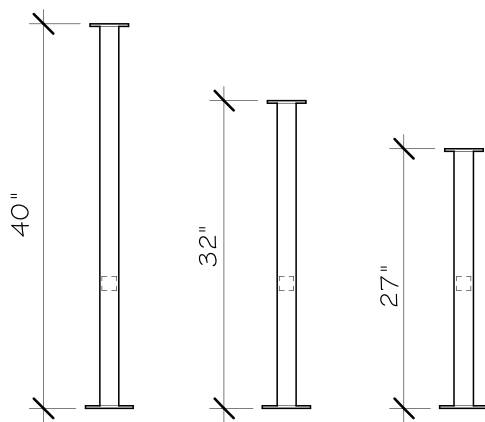

Front View

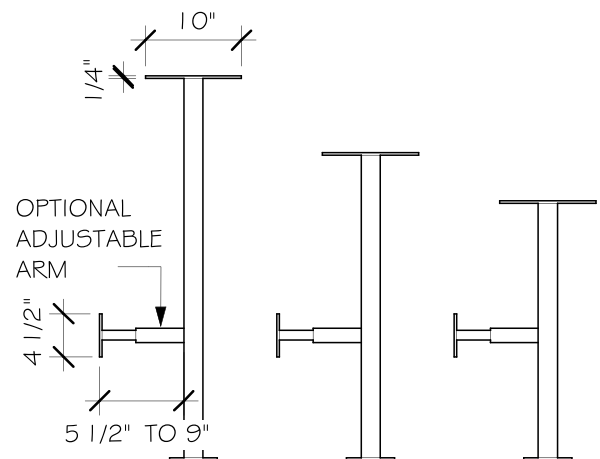

— CONTACT US FOR CUSTOM SIZING —

Windfall Lumber
www.windfalllumber.com